

Super Duty Pickups F-250/F-350/F-450

Dimensions

2014

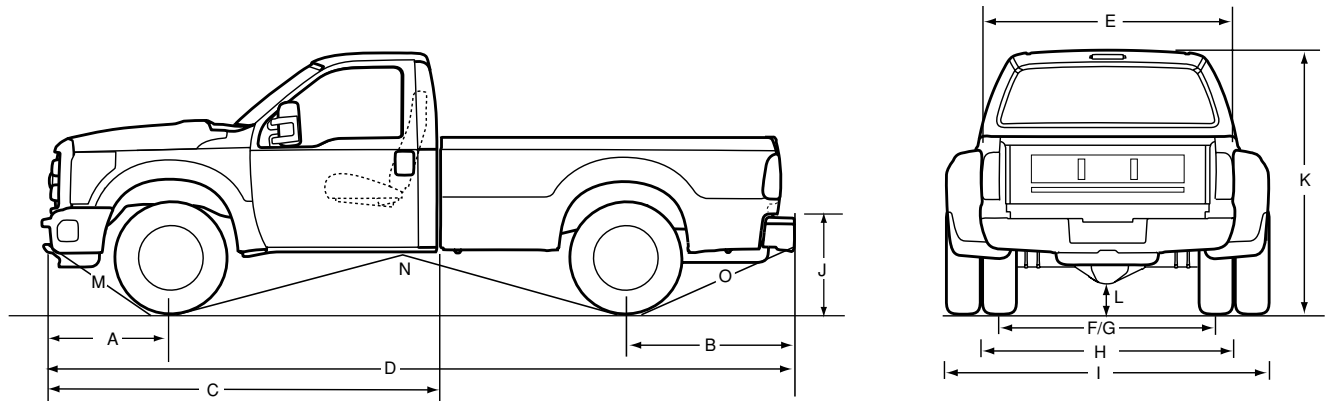

Super Duty Pickups
F-250/F-350/F-450

Body Dimensions REGULAR CAB PICKUP

Super Duty Series		F-250		F-350	
Drive		4x2	4x4	4x2	4x4
Wheelbase (in.)		137.0	137.0	137.0	137.0
Single/Dual Rear Wheel		SRW	SRW	SRW/DRW	SRW/DRW
Code	Description (in.)				
A	Front Overhang Length	38.1	38.1	38.1	38.1
B	Rear Overhang Length	52.4	52.4	52.4	52.4
C	Front Bumper To Back Of Cab Length	118.9	118.9	118.9	118.9
D	Overall Length	227.6	227.6	227.6	227.6
E	Vehicle Width (excluding mirrors)	79.9	79.9	79.9/96.0	79.9/96.0
F	Front Track Width	68.3	68.3	68.3	68.3
G	Rear Track Width	67.2	67.2	67.2/—	67.2/—
H	Tire Center Width (DRW)	—	—	—/74.7	—/74.7
I	Tire Outside Width (DRW)	—	—	—/95.9	—/95.9
J	Open Tailgate To Ground Height (empty) ⁽¹⁾	35.2	36.3	34.7/35.0	38.5/36.4
K	Cab Height (empty) ⁽¹⁾	76.6	79.2	76.5/76.7	80.0/79.5
L	Minimum Running Ground Clearance	8.5	8.2	8.5/8.1	8.2/8.0
M	Approach Angle (loaded) (degrees)	18.0	19.4	18.1/18.2	18.8/19.2
N	Ramp Breakover Angle (loaded) (degrees)	17.5	20.4	17.2/17.5	21.5/20.4
O	Departure Angle (loaded) (degrees)	17.8	19.2	17.3/17.6	21.5/19.3

(1) Height data shown represents dimensions of a nominal vehicle with no options. Actual height may vary due to production tolerances.

FUEL TANK CAPACITY

Wheelbase (in.)	Availability	Location	Capacity (gallons)
137.0	Standard gasoline	Midship	35.0
	Standard diesel	Midship	26.0

NOTE: Please see the Major Product Summary pages and/or the Dealer Ordering Guide for availability.

Revised September 2013

esourcebook.dealerconnection.com

RE&T: 2014 Source Book

2014

Super Duty Pickups F-250/F-350/F-450

Dimensions cont'd

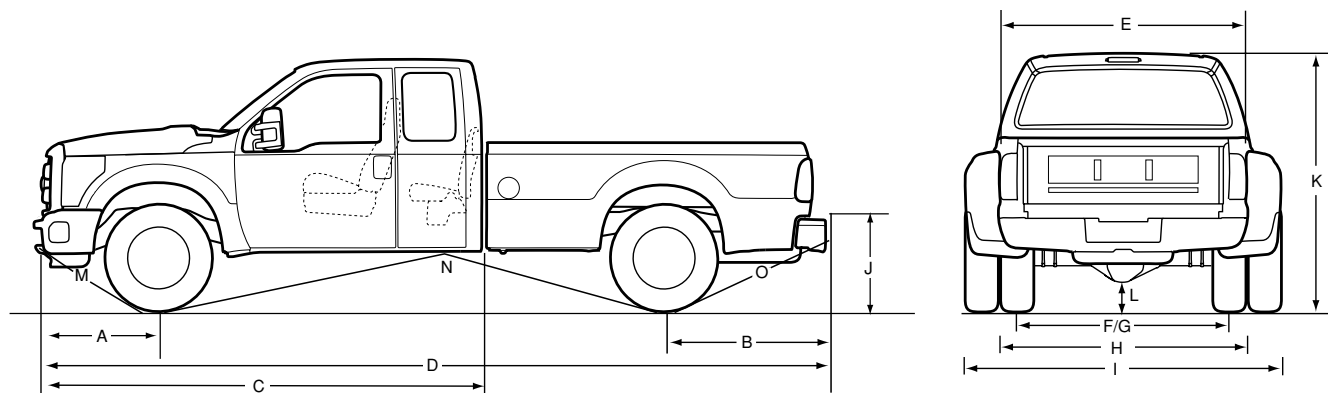

Body Dimensions (cont'd) SUPERCAB PICKUP

Super Duty Series		F-250				F-350			
Drive		4x2		4x4		4x2		4x4	
Wheelbase (in.)		141.8	158.0	141.8	158.0	141.8	158.0	141.8	158.0
Single/Dual Rear Wheel		SRW	SRW	SRW	SRW	SRW	SRW/DRW	SRW	SRW/DRW
Code	Description (in.)								
A	Front Overhang Length	38.1	38.1	38.1	38.1	38.1	38.1	38.1	38.1
B	Rear Overhang Length	52.4	52.4	52.4	52.4	52.4	52.4	52.4	52.4
C	Front Bumper To Back Of Cab Length	139.8	139.8	139.8	139.8	139.8	139.8	139.8	139.8
D	Overall Length	232.4	248.6	232.4	248.6	232.4	248.6	232.4	248.6
E	Vehicle Width (excluding mirrors)	79.9	79.9	79.9	79.9	79.9	79.9/96.0	79.9	79.9/96.0
F	Front Track Width	68.3	68.3	68.3	68.3	68.3	68.3	68.3	68.3
G	Rear Track Width	67.2	67.2	67.2	67.2	67.2	67.2/—	67.2	67.2/—
H	Tire Center Width (DRW)	—	—	—	—	—	—/74.7	—	—/74.7
I	Tire Outside Width (DRW)	—	—	—	—	—	—/95.9	—	—/95.9
J	Open Tailgate To Ground Height (empty) ⁽¹⁾	34.8	34.4	35.6	35.4	34.4	34.1/34.3	37.9	38.0/35.7
K	Cab Height (empty) ⁽¹⁾	77.0	76.9	79.5	79.3	76.9	76.7/76.9	80.4	80.2/79.7
L	Minimum Running Ground Clearance	8.5	8.5	8.2	8.1	8.5	8.5/8.1	8.2	8.2/8.0
M	Approach Angle (loaded) (degrees)	18.1	18.7	20.1	20.0	18.2	18.8/19.0	19.5	19.3/20.6
N	Ramp Breakover Angle (loaded) (degrees)	16.9	15.8	19.8	18.1	16.7	15.6/15.9	20.9	19.2/18.6
O	Departure Angle (loaded) (degrees)	17.4	17.0	18.5	18.3	17.0	16.6/16.9	20.9	21.1/18.7

(1) Height data shown represents dimensions of a nominal vehicle with no options. Actual height may vary due to production tolerances.

FUEL TANK CAPACITY

Wheelbase (in.)	Availability	Location	Capacity (gallons)
141.8	Standard gasoline	Midship	35.0
	Standard diesel	Midship	26.0
158.0	Standard gasoline	Midship	35.0
	Standard diesel	Midship	37.5

NOTE: Please see the Major Product Summary pages and/or the Dealer Ordering Guide for availability.

Super Duty Pickups F-250/F-350/F-450

Dimensions cont'd

2014

Super Duty Pickups
F-250/F-350/F-450

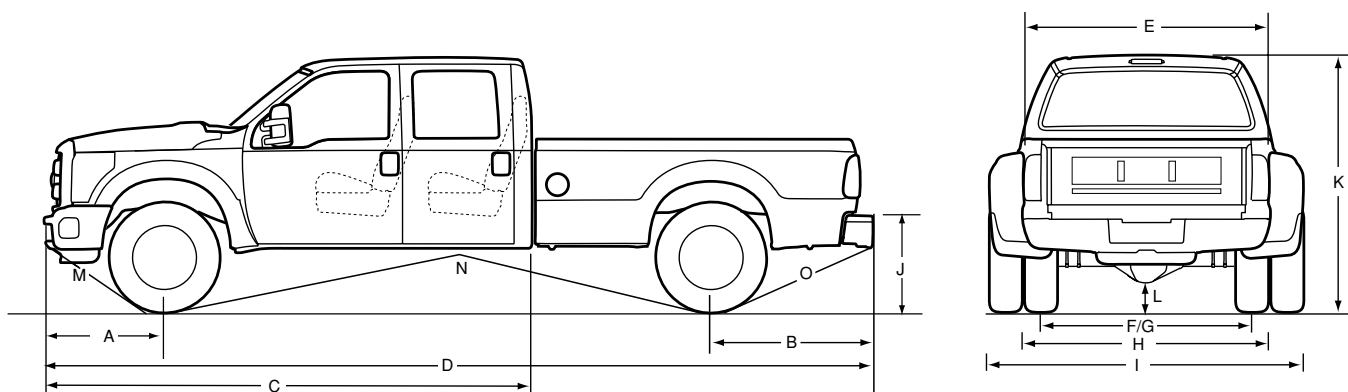

Body Dimensions (cont'd) CREW CAB PICKUP

Super Duty Series		F-250				F-350				F-450
Drive		4x2		4x4		4x2		4x4		4x4
Wheelbase (in.)		156.2	172.4	156.2	172.4	156.2	172.4	156.2	172.4	172.4
Single/Dual Rear Wheel		SRW	SRW	SRW	SRW	SRW	SRW/DRW	SRW	SRW/DRW	DRW
Code	Description (in.)									
A	Front Overhang Length	38.1	38.1	38.1	38.1	38.1	38.1	38.1	38.1	38.1
B	Rear Overhang Length	52.4	52.4	52.4	52.4	52.4	52.4	52.4	52.4	52.4
C	Front Bumper To Back Of Cab Length	154.2	154.2	154.2	154.2	154.2	154.2	154.2	154.2	154.2
D	Overall Length	246.8	263.0	246.8	263.0	246.8	263.0	246.8	263.0	263.0
E	Vehicle Width (excluding mirrors)	79.9	79.9	79.9	79.9	79.9	79.9/96.0	79.9	79.9/96.0	96.0
F	Front Track Width	68.3	68.3	68.3	68.3	68.3	68.3	68.3	68.3	74.8
G	Rear Track Width	67.2	67.2	67.2	67.2	67.2/—	67.2/—	67.2/—	67.2/—	75.9
H	Tire Center Width (DRW)	—	—	—	—	—	—/74.7	—	—/74.7	75.9
I	Tire Outside Width (DRW)	—	—	—	—	—	—/95.9	—	—/95.9	95.7
J	Open Tailgate To Ground Height (empty) ⁽¹⁾	34.2	34.1	35.1	35.0	33.9	33.8/34.1	37.8	37.7/35.6	35.4
K	Cab Height (empty) ⁽¹⁾	77.4	77.3	79.7	79.8	77.2	77.2/77.3	80.8	80.8/79.9	79.7
L	Minimum Running Ground Clearance	8.5	8.5	8.1	8.1	8.5	8.5/8.0	8.2	8.2/8.0	8.0
M	Approach Angle (loaded) (degrees)	18.7	18.9	20.0	20.6	18.8	19.0/19.1	19.3	20.0/20.3	19.8
N	Ramp Breakover Angle (loaded) (degrees)	15.7	15.0	18.1	17.3	15.5	14.8/15.0	19.2	18.2/17.4	17.0
O	Departure Angle (loaded) (degrees)	16.7	16.7	18.0	17.9	16.4	16.3/16.7	20.8	20.8/18.5	18.3

(1) Height data shown represents dimensions of a nominal vehicle with no options. Actual height may vary due to production tolerances.

FUEL TANK CAPACITY

Wheelbase (in.)	Availability	Location	Capacity (gallons)
156.2	Standard gasoline	Midship	35.0
	Standard diesel	Midship	26.0
172.4	Standard gasoline	Midship	35.0
	Standard diesel	Midship	37.5

NOTE: Please see the Major Product Summary pages and/or the Dealer Ordering Guide for availability.

Revised September 2013

esourcebook.dealerconnection.com

RE&T: 2014 Source Book

2014

Super Duty Pickups F-250/F-350/F-450

Dimensions cont'd

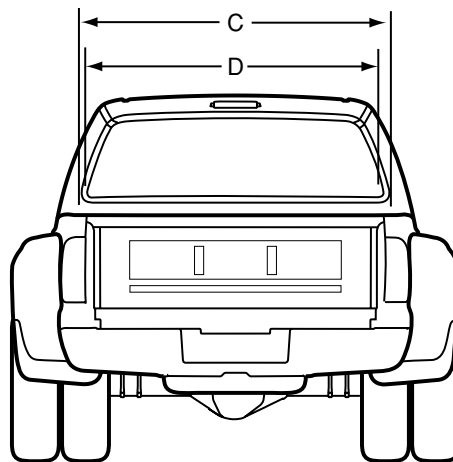
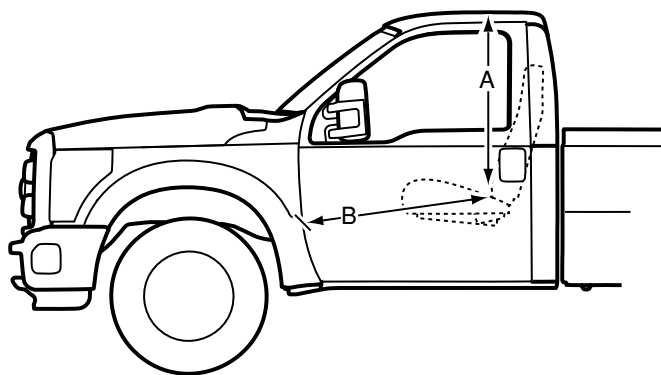

Body Dimensions (cont'd)

Cab Dimensions

Cab Style	Regular Cab	SuperCab	Crew Cab
Interior Volumes (cu. ft.)			
Passenger (Front)	65.9	65.9	65.9
Passenger (Rear)	—	47.4	67.6
Total Passenger	65.9	113.3	133.5
Cargo (Rear of Front Seat)	—	39.5	58.6
Code	Description (Front/Rear) (in.)		
A	Head Room	40.7/—	40.7/38.1
B	Leg Room	41.1/—	41.1/31.6
C	Shoulder Room	68.0/—	68.0/68.1
D	Hip Room	67.6/—	67.6/67.3

Super Duty Pickups F-250/F-350/F-450

Dimensions cont'd

2014

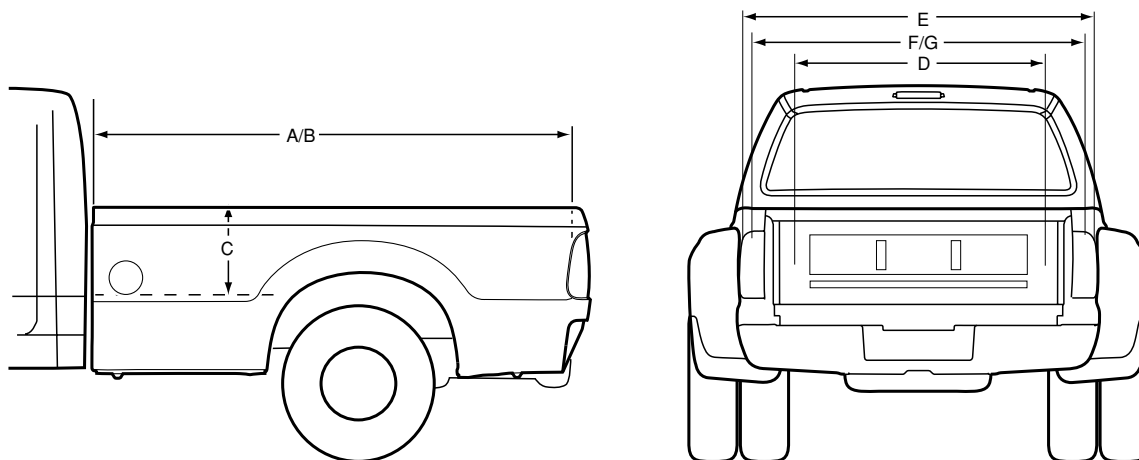

Pickup Box Dimensions STYLESIDE PICKUP BOX

Nominal Box Size (ft.)		6.75	8
Rear Wheels		SRW	SRW/DRW
Cargo Volume (cu. ft.)		64.1	77.3
Code	Description (in.)		
A	Cargo Length @ Floor	81.8	98.0
B	Cargo Length @ Top	80.1	96.3
C	Inside Height	20.0	20.0
D	Width Between Wheelhouses	50.9	50.9
E	Maximum Width @ Floor	69.3	69.3
F	Rear Opening Width @ Floor	60.6	60.6
G	Rear Opening Width @ Top	60.6	60.6

Super Duty Pickups
F-250/F-350/F-450

NOTE: Please see the Major Product Summary pages and/or the Dealer Ordering Guide for availability.

April 2013

esourcebook.dealerconnection.com

RE&T: 2014 Source Book

Super Duty Pickups F-250/F-350/F-450

Weight Ratings

F-250 Styleside Pickup/Pickup Box Delete⁽¹⁾ — GVWR/Payload/ARC/Spring and GAWR (Front Computer-selected Except with Snowplow)/Base Curb Weight

Cab Style/ Drive/ WB (in.)	Engine/ Trans- mission	Max. GVWR (lbs.) Std./Opt.	Max. Payload (lbs.) ⁽²⁾ Std./Opt.	OPT/ ARC Weight (lbs.) ⁽³⁾	Max. Std. Spring Select GAWR (lbs.) ⁽⁴⁾		Front Snow- plow	Base Curb Wt. (lbs.)		
					Front	Rear		Front	Rear	Total
Reg. Cab 4x2 — 137.0	6.2L/Auto	10,000/ 9900	4240/ 4130	2309	3950	6290/ 6200	—	3365	2576	5941
	6.7L/Auto	10,000/ 9900	3500/ 3400	1465	4550	6100	—	3942	2642	6584
Reg. Cab 4x4 — 137.0	6.2L/Auto	10,000/ 9900	3780/ 3630	1899	4400	6100	5600	3717	2634	6351
	6.7L/Auto	10,000/ 9900	3080/ 2980	1053	5200	6100	6000	4298	2698	6996
SuperCab 4x2 — 141.8	6.2L/Auto	10,000/ 9900	3860/ 3760	2020	4250	6200	—	3490	2740	6230
	6.7L/Auto	10,000/ 9900	3180/ 3080	2006	4850	6100	—	4086	2816	6902
SuperCab 4x2 — 158.0	6.2L/Auto	10,000/ 9900	3760/ 3660	1922	4400	6100	—	3583	2745	6328
	6.7L/Auto	10,000/ 9900	3010/ 2910	1843	5000	6100	—	4203	2862	7065
SuperCab 4x4 — 141.8	6.2L/Auto	10,000/ 9900	3450/ 3350	1621	4800	6100	5600/ 6000	3822	2807	6629
	6.7L/Auto	10,000/ 9900	2830/ 2730	1659	5200	6100	6000	4392	2857	7249
SuperCab 4x4 — 158.0	6.2L/Auto	10,000/ 9900	3350/ 3250	1519	4800	6100	6000	3938	2793	6731
	6.7L/Auto	10,000/ 9900	2620/ 2520	1452	5600	6100	6000	4562	2894	7456
Crew Cab 4x2 — 156.2	6.2L/Auto	10,000/ 9900	3640/ 3540	1808	4400	6100	—	3601	2841	6442
	6.7L/Auto	10,000/ 9900	2980/ 2880	1807	5000	6100	—	4188	2913	7101
Crew Cab 4x2 — 172.4	6.2L/Auto	10,000/ 9900	3540/ 3440	1703	4550	6100	—	3699	2848	6547
	6.7L/Auto	10,000/ 9900	2800/ 2700	1634	5250	6100	—	4309	2965	7274
Crew Cab 4x4 — 156.2	6.2L/Auto	10,000/ 9900	3250/ 3150	1422	4800	6100	6000	3945	2883	6828
	6.7L/Auto	10,000/ 9900	2620/ 2520	1451	5600	6100	6000	4507	2950	7457
Crew Cab 4x4 — 172.4	6.2L/Auto	10,000/ 9900	3140/ 3040	1308	5200	6100	6000	4060	2882	6942
	6.7L/Auto	10,000/ 9900	2410/ 2310	1245	5600	6100	6000	4661	3002	7663

(1) Pickup Box Delete available with Regular Cab 137" WB, SuperCab 158" WB and Crew Cab 172.4" WB models with 6.2L or 6.7L engines only. Base Curb Weights shown above are for completed pickup truck models with standard equipment and the engine/transmission combination indicated. To adjust the "Base Curb Weight" to reflect Pickup Box Delete, add 36 lbs. to the "Front" weight and subtract 545 lbs. from the "Total" weight (adjust the "Rear" weight by subtracting "Front" from "Total"). This provides the weight effect of deleting the pickup box, rear step bumper and standard spare tire, wheel and carrier. Please also refer to footnote 3.

(2) Load rating represents maximum allowable weight of people, cargo and body equipment and is reduced by optional equipment weight.

(3) OPT/ARC Weight is the maximum allowable weight for regular production options (OPT) and aftermarket equipment (Accessory Reserve Capacity) for completed pickup truck models with standard equipment and the powertrain combination indicated. To adjust the OPT/ARC weights to reflect Pickup Box Delete, add 545 lbs. Please also refer to footnote 1.

(4) Gross Axle Weight Rating is determined by the rated capacity of the minimum component of the axle system (axle, computer-selected springs, wheels, tires) of a specific vehicle. Front and rear GAWRs will, in all cases, sum to a number equal to or greater than the GVWR for the particular vehicle. Maximum loaded vehicle (including passengers, equipment and payload) cannot exceed the GVW rating or GAWR (front or rear).

NOTE: Refer to page 79 for Standard Powertrain/Chassis Equipment Specifications.

NOTE: The standard front spring/GAWR on Pickup models is computer-selected based on the total front weight of options ordered. Front spring/GAWR upgrades range from 3800 lbs. to 5250 lbs. (4x2) and 4400 lbs. to 6000 lbs. (4x4). Certain packages include the following front spring/GAWR upgrades: Heavy Service Front Suspension Package and Heavy Service Package For Pickup Box Delete — Front springs/GAWR will be selected 1 upgrade higher than standard computer selection; Camper Package — Front springs/GAWR will be selected 2 upgrades higher than standard computer selection on 4x2 models and 1 upgrade higher than standard computer selection on 4x4 models; Snowplow Package — Front springs/GAWR is assigned or specifically selected as shown in the chart above. Front spring/GAWR upgrade is not included if the maximum front spring has been computer-selected as a consequence of options ordered.

NOTE: Please see the Major Product Summary pages and/or the Dealer Ordering Guide for availability.

Super Duty Pickups F-250/F-350/F-450

Weight Ratings cont'd

2014

Super Duty Pickups
F-250/F-350/F-450

F-350 SRW Styleside Pickup/Pickup Box Delete⁽¹⁾ with 17" Tires/Wheels — GVWR/Payload/ARC/Spring and GAWR (Front Computer-selected Except with Snowplow)/Base Curb Weight

Cab Style/Drive/WB (in.)	Engine/Transmission	Max. GVWR (lbs.) Std./Opt.	Max. Payload (lbs.) ⁽²⁾ Std./Opt.	OPT/ARC Weight (lbs.) ⁽³⁾	Max. Std. Spring Select GAWR (lbs.) ⁽⁴⁾		Front Snowplow	Base Curb Wt. (lbs.)		
					Front	Rear		Front	Rear	Total
Regular Cab 4x2 — 137.0	6.2L/Auto	10,000/10,000	4080/4080	2240	3950	6290	—	3365	2645	6010
Regular Cab 4x2 — 137.0	6.7L/Auto	10,500/10,000	3930/3430	1398	4550	6290	—	3941	2710	6651
Regular Cab 4x4 — 137.0	6.2L/Auto	10,400/10,000	4060/3660	1827	4400	6290	5600	3732	2691	6423
Regular Cab 4x4 — 137.0	6.7L/Auto	10,800/10,000	3810/3010	978	5200	6290	6000	4297	2774	7071
SuperCab 4x2 — 141.8	6.2L/Auto	10,000/10,000	3790/3790	1952	4250	6290	—	3490	2808	6298
SuperCab 4x2 — 141.8	6.7L/Auto	10,700/10,000	3810/3110	1940	4850	6290	—	4085	2883	6968
SuperCab 4x2 — 158.0	6.2L/Auto	10,200/10,000	3920/3720	1883	4400	6290	—	3583	2784	6367
SuperCab 4x2 — 158.0	6.7L/Auto	10,800/10,000	3780/2980	1807	5000	6290	—	4202	2899	7101
SuperCab 4x4 — 141.8	6.2L/Auto	10,500/10,000	3900/3400	1564	4800	6290	6000	3822	2864	6686
SuperCab 4x4 — 141.8	6.7L/Auto	11,100/10,000	3850/2750	1583	5200	6290	6000	4391	2934	7325
SuperCab 4x4 — 158.0	6.2L/Auto	10,700/10,000	4010/3310	1481	4800	6290	5600	3938	2831	6769
SuperCab 4x4 — 158.0	6.7L/Auto	11,200/10,000	3770/2570	1405	5600	6290	6000	4541	2962	7503
Crew Cab 4x2 — 156.2	6.2L/Auto	10,200/10,000	3800/3600	1769	4400	6290	—	3601	2880	6481
Crew Cab 4x2 — 156.2	6.7L/Auto	10,800/10,000	3740/2940	1770	5000	6290	—	4187	2951	7138
Crew Cab 4x2 — 172.4	6.2L/Auto	10,500/10,000	3970/3470	1635	4550	6290	—	3699	2916	6615
Crew Cab 4x2 — 172.4	6.7L/Auto	11,100/10,000	3870/2770	1597	5250	6290	—	4309	3002	7311
Crew Cab 4x4 — 156.2	6.2L/Auto	10,600/10,000	3810/3210	1384	4800	6290	6000	3945	2921	6866
Crew Cab 4x4 — 156.2	6.7L/Auto	11,200/10,000	3750/2550	1385	5600	6290	6000	4521	3002	7523
Crew Cab 4x4 — 172.4	6.2L/Auto	10,800/10,000	3900/ 3100	1271	5200/4800	6290	6000	4060	2919	6979
Crew Cab 4x4 — 172.4	6.7L/Auto	11,200/10,000	3560/2360	1193	5600	6290	6000	4665	3050	7715

- (1) Pickup Box Delete available with Regular Cab 137" WB, SuperCab 158" WB and Crew Cab 172.4" WB models with 6.2L or 6.7L engines only. Base Curb Weights shown above are for completed pickup truck models with standard equipment and the engine/transmission combination indicated. To adjust the "Base Curb Weight" to reflect Pickup Box Delete, add 36 lbs. to the "Front" weight and subtract 545 lbs. from the "Total" weight (adjust the "Rear" weight by subtracting "Front" from "Total"). This provides the weight effect of deleting the pickup box, rear step bumper and standard spare tire, wheel and carrier. Please also refer to footnote 3.
- (2) Load rating represents maximum allowable weight of people, cargo and body equipment and is reduced by optional equipment weight.
- (3) OPT/ARC Weight is the maximum allowable weight for regular production options (OPT) and aftermarket equipment (Accessory Reserve Capacity) for completed pickup truck models with standard equipment and the powertrain combination indicated. To adjust the OPT/ARC weights to reflect Pickup Box Delete, add 545 lbs. Please also refer to footnote 1.
- (4) Gross Axle Weight Rating is determined by the rated capacity of the minimum component of the axle system (axle, computer-selected springs, wheels, tires) of a specific vehicle. Front and rear GAWRs will, in all cases, sum to a number equal to or greater than the GVWR for the particular vehicle. Maximum loaded vehicle (including passengers, equipment and payload) cannot exceed the GVW rating or GAWR (front or rear).

NOTE: Refer to page 80 for Standard Powertrain/Chassis Equipment Specifications.

NOTE: The standard front spring/GAWR on Pickup models is computer-selected based on the total front weight of options ordered. Front spring/GAWR upgrades range from 3800 lbs. to 5250 lbs. (4x2) and 4400 lbs. to 6000 lbs. (4x4). Certain packages include the following front spring/GAWR upgrades: Heavy Service Front Suspension Package and Heavy Service Package For Pickup Box Delete — Front springs/GAWR will be selected 1 upgrade higher than standard computer selection; Camper Package — Front springs/GAWR will be selected 2 upgrades higher than standard computer selection on 4x2 models and 1 upgrade higher than standard computer selection on 4x4 models; Snowplow Package — Front springs/GAWR is assigned or specifically selected as shown in the chart above. Front spring/GAWR upgrade is not included if the maximum front spring has been computer-selected as a consequence of options ordered.

NOTE: Please see the Major Product Summary pages and/or the Dealer Ordering Guide for availability.

Revised September 2013

esourcebook.dealerconnection.com

RE&T: 2014 Source Book

2014

Super Duty Pickups F-250/F-350/F-450

Weight Ratings cont'd

F-350 SRW 4x2 Styleside Pickup/Pickup Box Delete⁽¹⁾ with 18" All-Season Tires/Wheels — GVWR/Payload/ARC/Spring and GAWR (Front Computer-selected Except with Snowplow)/Base Curb Weight

Cab Style/ Drive/ WB (in.)	Engine/ Trans- mission	Max. GVWR (lbs.) Std./Opt.	Max. Payload (lbs.) ⁽²⁾ Std./Opt.	OPT/ ARC Weight (lbs.) ⁽³⁾	Max. Std. Spring Select GAWR (lbs.) ⁽⁴⁾		Front Snow- plow	Base Curb Wt. (lbs.)		
					Front	Rear		Front	Rear	Total
Regular Cab 4x2 — 137.0	6.2L/Auto	10,500	4540	2184	3950	6730	—	3387	2679	6066
	6.7L/Auto	11,000	4390	1343	4550	6730	—	3962	2744	6706
SuperCab 4x2 — 141.8	6.2L/Auto	10,500	4250	1896	4250	6730	—	3512	2842	6354
	6.7L/Auto	11,000	4070	1884	4850	6730	—	4106	2918	7024
SuperCab 4x2 — 158.0	6.2L/Auto	10,900	4580	1827	4400	6730	—	3604	2819	6423
	6.7L/Auto	11,400	4330	1751	5250	6730	—	4224	2933	7157
	6.7L/Auto	11,500	4430	1751	5250	6730	—	4224	2933	7157
Crew Cab 4x2 — 156.2	6.2L/Auto	10,700	4260	1714	4400	6730	—	3622	2914	6536
	6.7L/Auto	11,400	4300	1714	5000	6730	—	4209	2984	7193
Crew Cab 4x2 — 172.4	6.2L/Auto	11,000	4430	1580	4550	6730	—	3720	2950	6670
	6.7L/Auto	11,400	4120	1542	5250	6730	—	4330	3036	7366
	6.7L/Auto	11,500	4220	1542	5250	6730	—	4330	3036	7366

(1) Pickup Box Delete available with Regular Cab 137" WB, SuperCab 158" WB and Crew Cab 172.4" WB models with 6.2L or 6.7L engines only. Base Curb Weights shown above are for completed pickup truck models with standard equipment and the engine/transmission combination indicated. To adjust the "Base Curb Weight" to reflect Pickup Box Delete, add 36 lbs. to the "Front" weight and subtract 545 lbs. from the "Total" weight (adjust the "Rear" weight by subtracting "Front" from "Total"). This provides the weight effect of deleting the pickup box, rear step bumper and standard spare tire, wheel and carrier. Please also refer to footnote 3.

(2) Load rating represents maximum allowable weight of people, cargo and body equipment and is reduced by optional equipment weight.

(3) OPT/ARC Weight is the maximum allowable weight for regular production options (OPT) and aftermarket equipment (Accessory Reserve Capacity) for completed pickup truck models with standard equipment and the powertrain combination indicated. To adjust the OPT/ARC weights to reflect Pickup Box Delete, add 545 lbs. Please also refer to footnote 1.

(4) Gross Axle Weight Rating is determined by the rated capacity of the minimum component of the axle system (axle, computer-selected springs, wheels, tires) of a specific vehicle. Front and rear GAWRs will, in all cases, sum to a number equal to or greater than the GVWR for the particular vehicle. Maximum loaded vehicle (including passengers, equipment and payload) cannot exceed the GVW rating or GAWR (front or rear).

NOTE: Refer to page 80 for Standard Powertrain/Chassis Equipment Specifications.

NOTE: The standard front spring/GAWR on Pickup models is computer-selected based on the total front weight of options ordered. Front spring/GAWR upgrades range from 3800 lbs. to 5250 lbs. (4x2) and 4400 lbs. to 6000 lbs. (4x4). Certain packages include the following front spring/GAWR upgrades: Heavy Service Front Suspension Package and Heavy Service Package For Pickup Box Delete — Front springs/GAWR will be selected 1 upgrade higher than standard computer selection; Camper Package — Front springs/GAWR will be selected 2 upgrades higher than standard computer selection on 4x2 models and 1 upgrade higher than standard computer selection on 4x4 models; Snowplow Package — Front springs/GAWR is assigned or specifically selected as shown in the chart above. Front spring/GAWR upgrade is not included if the maximum front spring has been computer-selected as a consequence of options ordered.

NOTE: Please see the Major Product Summary pages and/or the Dealer Ordering Guide for availability.

Super Duty Pickups F-250/F-350/F-450

Weight Ratings cont'd

2014

Super Duty Pickups
F-250/F-350/F-450

F-350 SRW 4x4 Styleside Pickup/Pickup Box Delete⁽¹⁾ with 18" All-season Tires/Wheels — GVWR/Payload/ARC/Spring and GAWR (Front Computer-selected Except with Snowplow)/Base Curb Weight

Cab Style/Drive/WB (in.)	Engine/Transmission	Max. GVWR (lbs.) Std./Opt.	Max. Payload (lbs.) ⁽²⁾ Std./Opt.	OPT/ARC Weight (lbs.) ⁽³⁾	Max. Std. Spring Select GAWR (lbs.) ⁽⁴⁾		Front Snowplow	Base Curb Wt. (lbs.)		
					Front	Rear		Front	Rear	Total
Regular Cab 4x4 — 137.0	6.2L/Auto	10,500	4110	1767	4400	6730	5600	3735	2748	6483
	6.7L/Auto	11,000	3970	923	5200	6730	6000	4319	2807	7126
SuperCab 4x4 — 141.8	6.2L/Auto	10,600	3950	1509	4800	6730	6000	3843	2898	6741
	6.7L/Auto	11,200	3910	1528	5200	6730	6000	4413	2967	7380
SuperCab 4x4 — 158.0	6.2L/Auto	10,800	4070	1426	4800	6730	6000	3960	2864	6824
	6.7L/Auto	11,300	3830	1350	5600	6730	6000	4562	2996	7558
Crew Cab 4x4 — 156.2	6.2L/Auto	10,800	3970	1328	4800	6730	6000	3967	2955	6922
	6.7L/Auto	11,300	3810	1329	5600	6730	6000	4542	3037	7579
Crew Cab 4x4 — 172.4	6.2L/Auto	11,000	4060	1215	5200	6730	6000	4081	2954	7035
	6.7L/Auto	11,300	3610	1137	5600	6730	6000	4687	3084	7771

(1) Pickup Box Delete available with Regular Cab 137" WB, SuperCab 158" WB and Crew Cab 172.4" WB models with 6.2L or 6.7L engines only. Base Curb Weights shown above are for completed pickup truck models with standard equipment and the engine/transmission combination indicated. To adjust the "Base Curb Weight" to reflect Pickup Box Delete, add 36 lbs. to the "Front" weight and subtract 545 lbs. from the "Total" weight (adjust the "Rear" weight by subtracting "Front" from "Total"). This provides the weight effect of deleting the pickup box, rear step bumper and standard spare tire, wheel and carrier. Please also refer to footnote 3.

(2) Load rating represents maximum allowable weight of people, cargo and body equipment and is reduced by optional equipment weight.

(3) OPT/ARC Weight is the maximum allowable weight for regular production options (OPT) and aftermarket equipment (Accessory Reserve Capacity) for completed pickup truck models with standard equipment and the powertrain combination indicated. To adjust the OPT/ARC weights to reflect Pickup Box Delete, add 545 lbs. Please also refer to footnote 1.

(4) Gross Axle Weight Rating is determined by the rated capacity of the minimum component of the axle system (axle, computer-selected springs, wheels, tires) of a specific vehicle. Front and rear GAWRs will, in all cases, sum to a number equal to or greater than the GVWR for the particular vehicle. Maximum loaded vehicle (including passengers, equipment and payload) cannot exceed the GVW rating or GAWR (front or rear).

NOTE: Refer to page 80 for Standard Powertrain/Chassis Equipment Specifications.

NOTE: The standard front spring/GAWR on Pickup models is computer-selected based on the total front weight of options ordered. Front spring/GAWR upgrades range from 3800 lbs. to 5250 lbs. (4x2) and 4400 lbs. to 6000 lbs. (4x4). Certain packages include the following front spring/GAWR upgrades: Heavy Service Front Suspension Package and Heavy Service Package For Pickup Box Delete — Front springs/GAWR will be selected 1 upgrade higher than standard computer selection; Camper Package — Front springs/GAWR will be selected 2 upgrades higher than standard computer selection on 4x2 models and 1 upgrade higher than standard computer selection on 4x4 models; Snowplow Package — Front springs/GAWR is assigned or specifically selected as shown in the chart above. Front spring/GAWR upgrade is not included if the maximum front spring has been computer-selected as a consequence of options ordered.

NOTE: Please see the Major Product Summary pages and/or the Dealer Ordering Guide for availability.

Revised September 2013

esourcebook.dealerconnection.com

RE&T: 2014 Source Book

2014

Super Duty Pickups F-250/F-350/F-450

Weight Ratings cont'd

F-350 SRW 4x4 Styleside Pickup/Pickup Box Delete⁽¹⁾ with 18" (Inc. 20" with Diesel) All-terrain Tires/Wheels — GVWR/Payload/ARC/Spring and GAWR (Front Computer-selected Except with Snowplow)/Base Curb Weight

Cab Style/Drive/WB (in.)	Engine/Transmission	Max. GVWR (lbs.) Std./Opt.	Max. Payload (lbs.) ⁽²⁾ Std./Opt.	OPT/ARC Weight (lbs.) ⁽³⁾	Max. Std. Spring Select GAWR (lbs.) ⁽⁴⁾		Front Snow-plow	Base Curb Wt. (lbs.)		
					Front	Rear		Front	Rear	Total
Regular Cab (with Camper Pkg.) 4x4 — 137.0	6.2L/Auto	11,300	4930	1733	4400	7180	5600	3748	2769	6517
		11,100	4680		4400	7000	5600	3748	2769	6517
	6.7L/Auto	11,400	4330	889	5200	7000	—	4332	2828	7160
SuperCab 4x4 — 141.8	6.7L/Auto	11,500	4430	889	5200	7000	6000	4332	2828	7160
	6.2L/Auto	11,100	4420	1475	4800	7000	5600	3856	2919	6775
	6.7L/Auto	11,400	4080	1496	5200	7000	—	4425	2987	7412
SuperCab 4x4 — 158.0	6.7L/Auto	11,500	4180	1496	5200	7000	6000	4425	2987	7412
	6.2L/Auto	11,000	4240	1392	4800	7000	5600	3873	2985	6858
	6.7L/Auto	11,400	3900	1319	5600	7000	—	4575	3014	7589
Crew Cab 4x4 — 156.2	6.7L/Auto	11,500	4000	1319	5600	7000	6000	4575	3014	7589
	6.2L/Auto	11,300	4440	1295	4800	7000	5600	3980	2975	6955
	6.7/Auto	11,400	3870	1293	5600	7000	—	4556	3059	7615
Crew Cab 4x4 — 172.4	6.7L/Auto	11,500	3970	1293	5600	7000	6000	4556	3059	7615
	6.2L/Auto	11,200	4220	1182	5200	7000	6000	4094	2974	7068
	6.7/Auto	11,400	3680	1104	5600	7000	—	4700	3104	7804
	6.7L/Auto	11,500	3780	1104	5600	7000	6000	4700	3104	7804

(1) Pickup Box Delete available with Regular Cab 137" WB, SuperCab 158" WB and Crew Cab 172.4" WB models with 6.2L or 6.7L engines only. Base Curb Weights shown above are for completed pickup truck models with standard equipment and the engine/transmission combination indicated. To adjust the "Base Curb Weight" to reflect Pickup Box Delete, add 36 lbs. to the "Front" weight and subtract 545 lbs. from the "Total" weight (adjust the "Rear" weight by subtracting "Front" from "Total"). This provides the weight effect of deleting the pickup box, rear step bumper and standard spare tire, wheel and carrier. Please also refer to footnote 3.

(2) Load rating represents maximum allowable weight of people, cargo and body equipment and is reduced by optional equipment weight.

(3) OPT/ARC Weight is the maximum allowable weight for regular production options (OPT) and aftermarket equipment (Accessory Reserve Capacity) for completed pickup truck models with standard equipment and the powertrain combination indicated. To adjust the OPT/ARC weights to reflect Pickup Box Delete, add 545 lbs. Please also refer to footnote 1.

(4) Gross Axle Weight Rating is determined by the rated capacity of the minimum component of the axle system (axle, computer-selected springs, wheels, tires) of a specific vehicle. Front and rear GAWRs will, in all cases, sum to a number equal to or greater than the GVWR for the particular vehicle. Maximum loaded vehicle (including passengers, equipment and payload) cannot exceed the GVW rating or GAWR (front or rear).

NOTE: Refer to page 80 for Standard Powertrain/Chassis Equipment Specifications.

NOTE: The standard front spring/GAWR on Pickup models is computer-selected based on the total front weight of options ordered. Front spring/GAWR upgrades range from 3800 lbs. to 5250 lbs. (4x2) and 4400 lbs. to 6000 lbs. (4x4). Certain packages include the following front spring/GAWR upgrades: Heavy Service Front Suspension Package and Heavy Service Package For Pickup Box Delete — Front springs/GAWR will be selected 1 upgrade higher than standard computer selection; Camper Package — Front springs/GAWR will be selected 2 upgrades higher than standard computer selection on 4x2 models and 1 upgrade higher than standard computer selection on 4x4 models; Snowplow Package — Front springs/GAWR is assigned or specifically selected as shown in the chart above. Front spring/GAWR upgrade is not included if the maximum front spring has been computer-selected as a consequence of options ordered.

NOTE: Please see the Major Product Summary pages and/or the Dealer Ordering Guide for availability.

Super Duty Pickups F-250/F-350/F-450

Weight Ratings cont'd

2014

F-350 DRW Styleside Pickup — GVWR/Payload/ARC/Spring and GAWR (Front Computer-selected)/Base Curb Weight

Cab Style/ Drive/ WB (in.)	Engine/ Trans- mission	Max. GVWR (lbs.) Std./Opt.	Max. Payload (lbs.) ⁽¹⁾ Std./Opt.	OPT/ ARC Weight (lbs.) ⁽²⁾	Max. Std. Spring Select GAWR (lbs.) ⁽³⁾		Front Snow- plow	Base Curb Wt. (lbs.)		
					Front	Rear		Front	Rear	Total
Regular Cab	6.2L/Auto	13,500	7260	411	4100	9650	—	3405	3028	6433
4x2 — 137.0	6.7L/Auto	14,000	7060	402	4700	9650	—	3981	3094	7075
Regular Cab	6.2L/Auto	13,800	7090	496	4800	9650	5600	3753	3097	6850
4x4 — 137.0	6.7L/Auto	14,000	6640	472	5200	9650	6000	4337	3158	7495
SuperCab	6.2L/Auto	13,900	7210	475	4550	9650	—	3629	3202	6831
4x2 — 158.0	6.7L/Auto	14,000	6560	474	5250	9650	—	4249	3325	7574
SuperCab	6.2L/Auto	14,000	6890	543	5200	9650	6000	3984	3258	7242
4x4 — 158.0	6.7L/Auto	14,000	6150	629	5600	9650	6000	4588	3389	7977
Crew Cab	6.2L/Auto	14,000	7080	641	4700	9650	—	3750	3307	7057
4x2 — 172.4	6.7L/Auto	14,000	6340	599	5250	9650	—	4361	3433	7794
Crew Cab	6.2L/Auto	14,000	6670	636	5200	9650	6000	4110	3350	7460
4x4 — 172.4	6.7L/Auto	14,000	5930	651	5600	9650	6000	4742	3453	8195

(1) Load rating represents maximum allowable weight of people, cargo and body equipment and is reduced by optional equipment weight.

(2) OPT/ARC Weight is the maximum allowable weight for regular production options (OPT) and aftermarket equipment (Accessory Reserve Capacity) for completed pickup truck models with standard equipment and the powertrain combination indicated. To adjust the OPT/ARC weights to reflect Pickup Box Delete, add 545 lbs.

(3) Gross Axle Weight Rating is determined by the rated capacity of the minimum component of the axle system (axle, computer-selected springs, wheels, tires) of a specific vehicle. Front and rear GAWRs will, in all cases, sum to a number equal to or greater than the GVWR for the particular vehicle. Maximum loaded vehicle (including passengers, equipment and payload) cannot exceed the GVW rating or GAWR (front or rear).

NOTE: Refer to page 81 for Standard Powertrain/Chassis Equipment Specifications.

NOTE: The standard front spring/GAWR on Pickup models is computer-selected based on the total front weight of options ordered. Front spring/GAWR upgrades range from 3800 lbs. to 5250 lbs. (4x2) and 4400 lbs. to 6000 lbs. (4x4). Certain packages include the following front spring/GAWR upgrades: Heavy Service Front Suspension Package and Heavy Service Package For Pickup Box Delete — Front springs/GAWR will be selected 1 upgrade higher than standard computer selection; Camper Package — Front springs/GAWR will be selected 2 upgrades higher than standard computer selection on 4x2 models and 1 upgrade higher than standard computer selection on 4x4 models; Snowplow Package — Front springs/GAWR is assigned or specifically selected as shown in the chart above. Front spring/GAWR upgrade is not included if the maximum front spring has been computer-selected as a consequence of options ordered.

NOTE: Please see the Major Product Summary pages and/or the Dealer Ordering Guide for availability.

Revised September 2013

esourcebook.dealerconnection.com

RE&T: 2014 Source Book

2014

Super Duty Pickups F-250/F-350/F-450

Weight Ratings cont'd

F-350 DRW Pickup Box Delete — GVWR/Payload/ARC/Spring and GVWR (Front Computer-selected)/Base Curb Weight

Cab Style/ Drive/ WB (in.)	Engine/ Transmission	Max. GVWR (lbs.) Std./Opt.	Max. Payload (lbs.) ⁽¹⁾ Std./Opt.	OPT/ ARC Weight (lbs.) ⁽²⁾	Max. Std. Spring Select GAWR (lbs.) ⁽³⁾		Front Snow-plow	Base Curb Wt. (lbs.)		
					Front	Rear		Front	Rear	Total
Reg. Cab 4x2 — 137.0	6.7L/Auto	13,000	6660	363	4700	9650	—	4020	2462	6482
Reg. Cab 4x4 — 137.0	6.7L/Auto	13,000	6240	—	5200	9650	—	4376	2526	6902
SuperCab 4x2 — 158.0	6.7L/Auto	13,000	6160	—	5250	9650	—	4288	2693	6981
SuperCab 4x4 — 158.0	6.7L/Auto	13,000	5750	—	5600	9650	—	4627	2757	7384
Crew Cab 4x2 — 172.4	6.7L/Auto	13,000	5930	—	5250	9650	—	4400	2801	7201
Crew Cab 4x4 — 172.4	6.7L/Auto	13,000	5530	—	5940	9650	—	4781	2821	7602

F-450 DRW Styleside Pickup — GVWR/Payload/ARC/Spring and GAWR (Front Computer-selected Except with Snowplow)/Base Curb Weight

Cab Style/ Drive/ WB (in.)	Engine/ Transmission	Max. GVWR (lbs.) Std./Opt.	Max. Payload (lbs.) ⁽¹⁾ Std./Opt.	OPT/ ARC Weight (lbs.) ⁽²⁾	Max. Std. Spring Select GAWR (lbs.) ⁽³⁾		Front Snow-plow	Base Curb Wt. (lbs.)		
					Front	Rear		Front	Rear	Total
Crew Cab 4x4 — 172.4	6.7L/Auto	14,000	5880	645	5940	9100	6000	4763	3423	8186

(1) Load rating represents maximum allowable weight of people, cargo and body equipment and is reduced by optional equipment weight.

(2) OPT/ARC Weight is the maximum allowable weight for regular production options (OPT) and aftermarket equipment (Accessory Reserve Capacity) for completed pickup truck models with standard equipment and the powertrain combination indicated. To adjust the OPT/ARC weights to reflect Pickup Box Delete, add 545 lbs.

(3) Gross Axle Weight Rating is determined by the rated capacity of the minimum component of the axle system (axle, computer-selected springs, wheels, tires) of a specific vehicle. Front and rear GAWRs will, in all cases, sum to a number equal to or greater than the GVWR for the particular vehicle. Maximum loaded vehicle (including passengers, equipment and payload) cannot exceed the GVW rating or GAWR (front or rear).

NOTE: Refer to pages 81 and 82 for Standard Powertrain/Chassis Equipment Specifications.

NOTE: The standard front spring/GAWR on Pickup models is computer-selected based on the total front weight of options ordered. Front spring/GAWR upgrades range from 3800 lbs. to 5250 lbs. (4x2) and 4400 lbs. to 6000 lbs. (4x4). Certain packages include the following front spring/GAWR upgrades: Heavy Service Front Suspension Package and Heavy Service Package For Pickup Box Delete — Front springs/GAWR will be selected 1 upgrade higher than standard computer selection; Camper Package — Front springs/GAWR will be selected 2 upgrades higher than standard computer selection on 4x2 models and 1 upgrade higher than standard computer selection on 4x4 models; Snowplow Package — Front springs/GAWR is assigned or specifically selected as shown in the chart above. Front spring/GAWR upgrade is not included if the maximum front spring has been computer-selected as a consequence of options ordered.

NOTE: Please see the Major Product Summary pages and/or the Dealer Ordering Guide for availability.

Super Duty Pickups F-250/F-350/F-450

Standard Powertrain/Chassis Equipment Specifications

2014

F-250 Styleside Pickup/Pickup Box Delete⁽¹⁾

DRIVE:		4x2	4x4
POWERTRAIN:		Refer to the Ordering Guide for 50 States Usage	
Engine	— Type	6.2L flex-fuel V8	
Transmission	— Type	Automatic	
	— Speeds	6-speed SelectShift with Tow/Haul Mode	
Transfer Case	— Type	—	Part-time, 2-speed
	— Low/High Gear Ratio	—	2.72:1/1.00:1
AXLES:			
Front Axle	— Type	Twin I-beam IFS, Ford	Monobeam, Dana 60
	— Capacity (Rating @ Ground)	5250 lbs.	6000 lbs.
	— Hubs Type	—	Manual Locking
Rear Axle	— Type — Full-floating	Ford Sterling	Full Float Beam 10.5"
	— Capacity (Rating @ Ground)	6200 lbs.	
BRAKES:			
Front/Rear Disc	— Type	Dual-piston Pin-slider Calipers, Bolt-on Adapters, Wraparound Tie Bars	
	— Rotor Diameter — Front/Rear (in.)	14.29/14.29	
Power Assist Unit	— Type	Vacuum Boost	
	— Effective Diameter (in.)	9.84	
Anti-Lock System		4-wheel (4-channel) with RSC	
Parking Brake (Rear Brakes) (in.)		9.06 Drum-In-Hat (Foot-operated, Hand Release)	
ELECTRICAL:			
Alternator	— Rating	157 Amperes, 2100 Watts (single 200-amp or dual-combined 357-amp option with 6.7L V8 Diesel)	
Battery	— Type	Maintenance-free	
	— Rating	72 amp-hr, 650 CCA (gas), 12-volt; dual 78 amp-hr, 750 CCA with 6.7L Diesel	
Harnesses	— Type	Trailer 7/4-wire Harness and Connector/Trailer Brake Wiring/Feed Kit (In-cab, No Controller)	
FUEL TANK:	— Capacity	Gasoline: 35 gallon (137.0", 141.8", 156.2", 158.0" and 172.4" Wheelbase) Diesel: 26 gallon (137.0", 141.8" and 156.2" Wheelbase) 37.5 gallon (158.0" and 172.4" Wheelbase)	
JACK:	— Capacity	2-ton	
STEERING:	— Type	Power, Ford XR-51 (Includes Steering Damper)	
	— Ratio	20.49:1	20.41:1
SUSPENSION:			
Frame	— Type	Ladder-type, 36,000 psi Steel; Rear rails are upfit-friendly, open C-channel construction	
	— Section Modulus (cu. in.)	6.7	
Springs, Front	— Type	Coil, Computer-selected	
	— Rating @ Ground (min.)	Refer to page 72 for usage and ratings	
Springs, Rear	— Type	Leaf, Two-stage Variable-rate Main, Optional Leaf, Two-stage Variable Rate Main Plus Auxiliary	
	— Rating @ Ground (min.)	Refer to page 72 for usage and ratings	
Shock Absorbers	— Gas-type (in.)	1.38	
Stabilizer Bar		Front 33 mm	Front 28 mm
TIRES:	— Type	Steel-belted Radial, All-season, BSW	
	— Size	Refer to tire specifications section	
	— Spare Tire Carrier	Rear Underframe, Crank-down Type (Includes Lock)	
WHEELS:	— Type and Size	Five, 8-hole Disc, 17" x 7.5" J Steel	

(1) Available with Regular Cab, 158" WB SuperCab and 172.4" WB Crew Cab with 6.2L. Pickup Box Delete option allows aftermarket installation of a second unit body. For details refer to the Ford Body Builders Layout Book.

NOTE: Refer to page 72 for Standard and Available Weight Rating Specifications (GVWR/Payload/Spring and GAWR/Base Curb Weight).

NOTE: Please see the Major Product Summary pages and/or the Dealer Ordering Guide for availability.

2014

Super Duty Pickups F-250/F-350/F-450

Standard Powertrain/Chassis Equipment Specifications cont'd

F-350 SRW Styleside Pickup/Pickup Box Delete⁽¹⁾

DRIVE:		4x2	4x4
POWERTRAIN:		Refer to the Ordering Guide for 50 States Usage	
Engine	— Type	6.2L flex-fuel V8	
Transmission	— Type	Automatic	
	— Speeds	6-speed SelectShift with Tow/Haul Mode	
Transfer Case	— Type	—	Part-time, 2-speed
	— Low/High Gear Ratio	—	2.72:1/1.00:1
AXLES:			
Front Axle	— Type	Twin I-beam IFS, Ford	Monobeam, Dana 60
	— Capacity (Rating @ Ground)	5250 lbs.	6000 lbs.
	— Hubs Type	—	Manual Locking
Rear Axle	— Type — Full-floating	Ford Sterling	
	— Capacity (Rating @ Ground)	7280 lbs.	
BRAKES:			
Front/Rear Disc	— Type	Dual-piston Pin-slider Calipers, Bolt-on Adapters, Wraparound Tie Bars	
	— Rotor Diameter — Front/Rear (in.)	14.29/14.29	
Power Assist Unit	— Type	Vacuum Boost (gas) (Hydro-boost with 6.7L V8 Diesel)	
	— Effective Diameter (in.)	9.84	
Anti-Lock System		4-wheel (4-channel) with RSC	
Parking Brake (Rear Brakes) (in.)		9.06 Drum-In-Hat (Foot-operated, Hand Release)	
ELECTRICAL:			
Alternator	— Rating	157 Amperes, 2100 Watt (single 200-amp or dual-combined 357-amp option with 6.7L V8 Diesel)	
Battery	— Type	Maintenance-free	
	— Rating	72 amp-hr, 650 CCA (gas), 12-volt; dual 78 amp-hr, 750 CCA with 6.7L Diesel	
Harnesses	— Type	Trailer 7/4-wire Harness and Connector/Trailer Brake Wiring/Feed Kit (In-cab, No Controller)	
FUEL TANK:	— Capacity (gal.)	Gasoline: 35 (137.0", 141.8", 156.2", 158.0" and 172.4" Wheelbase) Diesel: 26 (137.0", 141.8" and 156.2" Wheelbase) 37.5 (158.0" and 172.4" Wheelbase)	
JACK:	— Capacity	2-ton	
STEERING:	— Type	Power, Ford XR-51 (Includes Steering Damper)	
	— Ratio	20.49:1	20.41:1
SUSPENSION:			
Frame	— Type	Ladder-type, 36,000 psi Steel; Rear rails are upfit-friendly, open C-channel construction	
	— Section Modulus (cu. in.)	6.7	
Springs, Front	— Type	Coil, Computer-selected	
	— Rating @ Ground (min.)	Refer to pages 73–76 for usage and ratings	
Springs, Rear	— Type	Leaf, Two-stage Variable-rate Main Plus Auxiliary	
	— Rating @ Ground (min.)	Refer to pages 73–76 for usage and ratings	
Shock Absorbers	— Gas-type (in.)	1.38	
Stabilizer Bar		Front 33 mm	Front 28 mm
TIRES:	— Type	Steel-belted Radial, All-season, BSW	
	— Size	Refer to tire specifications section	
	— Spare Tire Carrier	Rear Underframe, Crank-down Type (Includes Lock)	
WHEELS:	— Type and Size	Five, 8-hole Disc, 17" x 7.5" J Steel	

(1) Available with Regular Cab, 158" WB SuperCab and 172.4" WB Crew Cab only. Pickup Box Delete option allows aftermarket installation of a second unit body. For details refer to the Ford Body Builders Layout Book.

NOTE: Refer to pages 73–76 for Standard and Available Weight Rating Specifications (GVWR/Payload/Spring and GAWR/Base Curb Weight).

NOTE: Please see the Major Product Summary pages and/or the Dealer Ordering Guide for availability.

Super Duty Pickups F-250/F-350/F-450

Standard Powertrain/Chassis Equipment Specifications cont'd

2014

F-350 DRW Styleside Pickup/Pickup Box Delete⁽¹⁾

DRIVE:		4x2	4x4
POWERTRAIN:		Refer to the Ordering Guide for 50 States Usage	
Engine	— Type	6.2L flex-fuel V8	
Transmission	— Type	TorqShift Automatic	
	— Speeds	6-speed SelectShift with Tow/Haul Mode	
Transfer Case	— Type	—	Part-time, 2-speed
	— Low/High Gear Ratio	—	2.72:1/1.00:1
AXLES:			
Front Axle	— Type	Twin I-beam IFS, Ford	Monobeam, Dana 60
	— Capacity (Rating @ Ground)	5250 lbs.	6000 lbs.
	— Hubs Type	—	Manual Locking
Rear Axle	— Type — Full-floating	Dana Model 80	
	— Capacity (Rating @ Ground)	9650 lbs.	
BRAKES:			
Front/Rear Disc	— Type	Dual-piston Pin-slider Calipers, Bolt-on Adapters, Wraparound Tie Bars	
	— Rotor Diameter — Front/Rear (in.)	14.29/14.29	
Power Assist Unit	— Type	Hydro-boost	
	— Effective Diameter (in.)	1.56 Power Piston	
Anti-Lock System		4-wheel (3-channel)	
Parking Brake (Rear Brakes) (in.)		9.06 Drum-in-Hat (Foot-operated, Hand Release)	
ELECTRICAL:			
Alternator	— Rating	157 Amperes, 2100 Watt (single 200-amp or dual-combined 357-amp option with 6.7L V8 diesel)	
Battery	— Type	Maintenance-free	
	— Rating	72 amp-hr, 650 CCA (gas), 12-volt; dual 78 amp-hr, 750 CCA With 6.7L V8 Diesel	
Harnesses	— Type	Trailer 7/4-wire Harness and Connector/Trailer Brake Wiring/Feed Kit (In-cab, No Controller)	
FUEL TANK:	— Capacity (gal.)	Gasoline: 35 (137.0", 141.8", 156.2", 158.0" and 172.4" Wheelbase) Diesel: 26 (137.0", 141.8" and 156.2" Wheelbase) 37.5 (158.0" and 172.4" Wheelbase)	
JACK:	— Capacity	4-ton	
STEERING:	— Type	Power, Ford XR-51 (Includes Steering Damper)	
	— Ratio	20.49:1	20.41:1
SUSPENSION:			
Frame	— Type	Ladder-type, 36,000 psi Steel; Rear rails are upfit-friendly, open C-channel construction	
	— Section Modulus (cu. in.)	6.7	
Springs, Front	— Type	Coil, Computer-selected	
	— Rating @ Ground (min.)	Refer to pages 77 and 78 for usage and ratings	
Springs, Rear	— Type	Leaf, Two-stage Variable Rate Main Plus Auxiliary	
	— Rating @ Ground (min.)	Refer to pages 77 and 78 for usage and ratings	
Shock Absorbers	— Gas-Type (in.)	1.38	
Stabilizer Bar		Front 24 mm/Rear 22 mm	Front 24 mm/Rear 22 mm
TIRES:	— Type	Steel-belted Radial, All-season, BSW	
	— Size	Refer to tire specifications sections	
	— Spare Tire Carrier	Rear Underframe, Crank-down Type (Includes Lock)	
WHEELS:	— Type and Size	Seven, 8-hole Disc, 17" x 6.5" J Steel	

(1) Available with Regular Cab, 158" WB SuperCab and 172.4" WB Crew Cab only. Pickup Box Delete option allows aftermarket installation of a second unit body. For details refer to the Ford Body Builders Layout Book.

NOTE: Refer to pages 77 and 78 for Standard and Available Weight Rating Specifications (GVWR/Payload/Spring and GAWR/Base Curb Weight).

NOTE: Please see the Major Product Summary pages and/or the Dealer Ordering Guide for availability.

2014

Super Duty Pickups F-250/F-350/F-450

Standard Powertrain/Chassis Equipment Specifications cont'd

F-450 DRW Styleside Pickup

DRIVE:		4x4
POWERTRAIN:		Refer to the Ordering Guide for 50 States Usage
Engine	— Type	6.7L Power Stroke V8 Turbo Diesel (B20 Biodiesel capable)
Transmission	— Type	TorqShift Automatic
	— Speeds	6-speed SelectShift with Tow/Haul Mode
Transfer Case	— Type	Part-time, 2-speed
	— Low/High Gear Ratio	2.72:1/1.00:1
AXLES:		
Front Axle	— Type	Monobeam, Dana Super 60
	— Capacity (Rating @ Ground)	6000 lbs.
	— Hubs Type	Manual Locking
Rear Axle	— Type — Full-floating	Dana Model 80
	— Capacity (Rating @ Ground)	9650 lbs.
BRAKES:		
Front/Rear Disc	— Type	Dual-piston Pin-slider Calipers, Bolt-on Adapters, Wraparound Tie Bars
	— Rotor Diameter — Front/Rear (in.)	14.29/14.29
Power Assist Unit	— Type	Hydro-boost
	— Effective Diameter (in.)	1.56 Power Piston
Anti-Lock System		4-wheel (3-channel)
Parking Brake (Rear Brakes) (in.)		9.06 Drum-in-Hat (Foot-operated, Hand Release)
ELECTRICAL:		
Alternator	— Rating	157 Amperes, 2100 Watt (single 200-amp or dual-combined 357-amp option with 6.7L V8 Diesel)
Battery	— Type	Maintenance-free
	— Rating	Dual 78 amp-hr, 750 CCA
Harnesses	— Type	Trailer 7/4-wire Harness and Connector/Trailer Brake Wiring/Feed Kit (In-cab, No Controller)
FUEL TANK:	— Capacity (gal.)	37.5
JACK:	— Capacity	4-ton
STEERING:	— Type	Power, Ford XR-51 (Includes Steering Damper)
	— Ratio	20.41:1
SUSPENSION:		
Frame	— Type	Ladder Type, 36,000 psi Steel; Rear rails are upfit-friendly, open C-channel construction
	— Section Modulus (cu. in.)	6.7
Springs, Front	— Type	Coil, Assigned Rating
	— Rating @ Ground (min.)	Refer to page 78 for usage and ratings
Springs, Rear	— Type	Leaf, Two-Stage Variable Rate Main Plus Auxiliary
	— Rating @ Ground (min.)	Refer to page 78 for usage and ratings
Shock Absorbers	— Gas-Type (in.)	1.38
Stabilizer Bar		Front 32 mm/Rear 22 mm
TIRES:	— Type	Steel-belted Radial, All-season, BSW
	— Size	Refer to tire specifications section
	— Spare Tire Carrier	Rear Underframe, Crank-down Type (Includes Lock)
WHEELS:	— Type and Size	Seven, 8-hole Disc, 17" x 6.5" J Aluminum

NOTE: Refer to page 78 for Standard and Available Weight Rating Specifications (GVWR/Payload/Spring and GAWR/Base Curb Weight).

NOTE: Please see the Major Product Summary pages and/or the Dealer Ordering Guide for availability.

Super Duty Pickups F-250/F-350/F-450

Technical Specifications

2014

Super Duty Pickups
F-250/F-350/F-450

Axles

FRONT AXLE SPECIFICATIONS — 4x2

Super Duty Series/Model		F-250/F-350
Make		Ford
Max. Rating @ Ground (lbs.)		5250
Axle	— Type	Twin-I-beam w/Ball Joint Spindle
	— Material	Nodular Cast Iron
	— Spring Centers (in.)	45.5
Radius Arms	— No.	2
	— Material	Stamped, High-strength Low-alloy Steel
Ball Joint		Lubed-for-Life Ball Joints
Spindle	— Material	Nodular Cast Iron Body w/Forged Steel Stem
Wheel Bearings	— Type	Tapered Roller

FRONT AXLE SPECIFICATIONS — 4x4

Super Duty Series/Model		F-250/F-350	F-450
Make		Dana Super 60	Dana Super 60
Axle Ratio		3.31/3.55/3.73/4.30	4.30
Max. Rating @ Ground (lbs.)		5600/6000	6000
Axle	— Type	Monobeam, Live Spindle	
	Material	Forged Steel	
Spring Centers (in.)		46.45	
Housing	— Type	Unitized	
	— Cover Attachment	Bolted	
Radius Arms	— No.	2	
	— Material	Stamped, High-strength Low-alloy Steel	
Wheel Bearings	— Type	Tapered Roller	
Gears	— Type	Hypoid	
Ring Gear	— Pitch Diameter (in.)	10.0	
Pinion	— Mounting	Above Center	
Differential	— Type	2-pinion	
	— Bearings	Tapered Roller	
Axle Shaft	— Minimum Diameter (in.)	1.356	
	— Diameter over Splines (in.)	1.47	
	— No. of Splines (Hub End)	35	

NOTE: Please see the Major Product Summary pages and/or the Dealer Ordering Guide for availability.

April 2013

esourcebook.dealerconnection.com

RE&T: 2014 Source Book

Super Duty Pickups

F-250/F-350/F-450

Technical Specifications cont'd

Axles (cont'd)

REAR AXLE SPECIFICATIONS

Model	F-250	F-350 SRW	F-350 DRW Pickup	F-450 DRW Pickup
Make (Standard and Limited Slip)	Ford Sterling	Ford Sterling	Dana 80	Dana 80
Max. Rating @ Ground (lbs.)	6200	7280	9650	9650
Type	Full-floating			
Driveline Attachment	Circular Flange			
Housing	Cast Center			
— Type	Bolted			
— Cover Attachment				
Section	3.50		4.00	
— Tube Dia. (in.)				
Synthetic Lubricant Capacity (pt.)	7.0		8.87	
Spring Centers (in.)	45.0			
Wheel Bearings	Tapered Roller			
— Type	Hypoid			
Gears	Alloy Steel			
— Material				
Ring Gear	10.50		11.25	
— Pitch Dia. (in.)				
Pinion	Overhung			
— Mounting				
Differential	(1)		2-pinion	(2)
— Type				
Axle Shaft	1.36	1.50	1.35	
— Spline Minor Dia. (in.)				
— Spline Major Dia. (in.)	1.50	1.57	1.42	
— No. of Splines (Hub End)	35	37	35	

(1) 2-pinion with 6.2L (378 CID) SEFI V8. 3-pinion with 6.7L (409 CID) OHV V8 turbo diesel engine.

(2) 4-pinion with limited slip.

Brakes

HYDRAULIC BRAKE EQUIPMENT SPECIFICATIONS — FRONT/REAR DISC

Type	Super Duty Series/Model	Axle Usage (lbs.)	Rotor Dia. (in.) OD ID	Brake Lining Segment	Area (sq. in.)/ Width (in.)/ Thickness (in.)	Caliper Piston No. Dia. (in.)	Gross Lining Area Per Axle (sq. in.)	Total Swept Area Per Axle (sq. in.)
Front Disc	F-250/F-350	5250/6000	14.29 9.09	Outboard	14.92/2.68/0.41	Dual/2.36	59.7	381.81
				Inboard	14.92/2.68/0.41			
	F-350 DRW	6000	14.29 9.09	Outboard	14.92/2.68/0.41	Dual/2.36	59.7	381.81
				Inboard	14.92/2.68/0.41			
	F-450	6000	14.29 9.09	Outboard	14.92/2.68/0.41	Dual/2.36	59.7	381.81
				Inboard	14.92/2.68/0.41			
Rear Disc	F-250/F-350 SRW	6200/7280	14.29 9.09	Outboard	11.45/2.24/0.41	Dual/1.89	45.82	334.9
				Inboard	11.45/2.24/0.41			
	F-350 DRW	9650	14.29 9.88	Outboard	11.45/2.24/0.41	Dual/2.13	45.82	334.9
				Inboard	11.45/2.24/0.41			
	F-450	9650	14.29 9.88	Outboard	11.45/2.24/0.41	Dual/2.13	45.82	334.9
				Inboard	11.45/2.24/0.41			

BRAKE MASTER CYLINDER SPECIFICATIONS

Type	Model/Series	Bore Dia. (in.)	Booster Type
Dual System, Dash-mounted	All F-250/F-350 (Gas engine)	1.3125	Vacuum
	F-350 (Diesel)/F-450	1.50	Hydro

BRAKES BOOSTER SPECIFICATIONS

Make/Type	Super Duty Series/Model	Booster Type	Effective Dia. (in.)	Diaphragm Type
Dash-mounted	All F-250/F-350 (Gas engine)	Vacuum Boost	9.84	Dual
	F-350 (Diesel)/F-450	Hydro	1.56	Power Piston

NOTE: Please see the Major Product Summary pages and/or the Dealer Ordering Guide for availability.

Super Duty Pickups F-250/F-350/F-450

Technical Specifications cont'd

2014

Cooling Systems

COOLING SYSTEM SPECIFICATIONS

Radiator													
Engine	Cooling	Trans. Usage	Frontal Area (sq. in.)	Core Size (in.)			Rows of Tubes	Fins Per Inch	Cooling System Capacity qts. (liters)	In-Tank Trans. Cooler	Fan Specifications		
				Height	Width	Thick-ness					Type	No. of Blades	Blade Dia. (in.)
6.2L FFV V8	Standard	All	837	27.5	30.43	1.02	1	12.1	21.0 (20.0)	Standard	Plastic	8	20.0
6.7L Power Stroke V8 Turbo Diesel Main Loop	Standard	All	1102	28.7	38.36	1.65	1	16.0	27.8 (26.3)	None	Plastic	9	24.57
6.7L Power Stroke V8 Turbo Diesel Secondary Loop	Standard	All	828	21.0	39.37	1.65	1	18	11.05 (10.4)	Frame-mounted Oil-to-Coolant Heat Exchanger	(1)	(1)	(1)

(1) One fan for both systems.

AUXILIARY AUTOMATIC TRANSMISSION OIL COOLER APPLICATIONS

Model	Engine	Transmission	Cooler — No. of Channels
All	6.2L FFV V8	6-speed SelectShift Automatic with Tow/Haul Mode	16
	6.7L Power Stroke V8 Turbo Diesel	6-speed SelectShift Automatic with Tow/Haul Mode	None

Fuel System

FUEL SYSTEM DATA

Electronic Fuel Injection	6.2L FFV V8	Sequential Multi-port Fuel Injection
	6.7L Power Stroke V8 Turbo Diesel	High-pressure Common Rail Fuel System
Fuel Pump	6.2L FFV V8	Single Electric-in-tank High-pressure (One Per Tank)
Fuel Filter	6.2L FFV V8	In-tank Large Capacity (One)
	6.7L Power Stroke V8 Turbo Diesel	Full-flow, Disposable Filter/In-line Water Separator
Air Cleaner	All Engines	Dry Element, Replaceable

NOTE: Please see the Major Product Summary pages and/or the Dealer Ordering Guide for availability.

April 2013

esourcebook.dealerconnection.com

RE&T: 2014 Source Book

Super Duty Pickups
F-250/F-350/F-450

2014

Super Duty Pickups F-250/F-350/F-450

Technical Specifications cont'd

Steering

STEERING SPECIFICATIONS

Cab Style/ Drive	Series/ Body Style	Wheelbase (in.)	Power Steering ⁽¹⁾		Turning Diameter (ft.)	
			Gear Ratio	Overall Ratio	Curb-to-Curb	Wall-to-Wall
Regular Cab 4x2	Pickup	137.0 SRW	18.14	20.49:1	47.7	49.6
		137.0 DRW	18.14	20.49:1	47.7	49.6
Regular Cab 4x4	Pickup	137.0 SRW	18.14	20.41:1	46.1	48.0
		137.0 DRW	18.14	20.41:1	46.1	48.0
SuperCab 4x2	Pickup	141.8 SRW	18.14	20.49:1	49.1	51.1
		158.0 SRW	18.14	20.49:1	54.1	56.0
		158.0 DRW	18.14	20.49:1	54.1	56.0
SuperCab 4x4	Pickup	141.8 SRW	18.14	20.41:1	47.5	49.4
		158.0 SRW	18.14	20.41:1	52.3	54.2
		158.0 DRW	18.14	20.41:1	52.3	54.2
Crew Cab 4x2	F-250/F-350 Pickup	156.2 SRW	18.14	20.49:1	53.5	55.5
		156.2 DRW	18.14	20.49:1	53.6	55.5
		172.4 SRW	18.14	20.49:1	58.5	60.4
		172.4 DRW	18.14	20.49:1	58.5	60.4
Crew Cab 4x4	F-250/F-350 Pickup	156.2 SRW	18.14	20.41:1	51.8	53.7
		156.2 DRW	18.14	20.41:1	51.8	53.7
		172.4 SRW	18.14	20.41:1	56.5	58.4
		172.4 DRW	18.14	20.41:1	56.6	58.4
	F-450 Pickup	172.4 DRW	18.14	20.41:1	50.4	52.5

(1) Power steering fluid cooler is standard.

Suspensions

FRAME SPECIFICATIONS

Cab Style	Super Duty Series/Model	Wheelbase (in.)	No. of Crossmembers	Maximum Side Rail Section (Height x Width x Thickness) (in.) ⁽¹⁾	Section Modulus (cu. in.) ⁽²⁾	Yield Strength (psi)
Regular Cab	F-250/F-350 Pickup/Box Delete	137.0	5	6.87 x 2.36 x .260	6.7	36,000
SuperCab	F-250/F-350 Pickup	141.8	6	6.87 x 2.36 x .260	6.7	36,000
	F-250/F-350 Pickup/Box Delete	158.0	6	6.87 x 2.36 x .260	6.7	36,000
Crew Cab	F-250/F-350 Pickup	156.2	6	6.87 x 2.36 x .260	6.7	36,000
	F-250/F-350/F-450 Pickup/Box Delete ⁽³⁾	172.4	6	6.87 x 2.36 x .260	6.7	36,000

(1) Measured to inside of metal.

(2) Cross-sectional modulus calculated at back of cab to inside of metal.

(3) Box Delete not available on F-450 Pickups.

SHOCK ABSORBER SPECIFICATIONS

Super Duty Model	Wheelbase (in.)	Usage	Front			Rear		
			No. Used	Piston Dia. (in.)	Type	No. Used	Piston Dia. (in.)	Type
Pickup	All	Std.	2	1.38	Gas-pressurized	2	1.38	Gas-pressurized

NOTE: Please see the Major Product Summary pages and/or the Dealer Ordering Guide for availability.

Super Duty Pickups F-250/F-350/F-450

Technical Specifications cont'd

2014

Super Duty Pickups
F-250/F-350/F-450

Suspensions (cont'd)

SPRING SPECIFICATIONS — FRONT COIL

Super Duty Series/Model	Combined Rating @ Ground (lbs.)	Height of Spring @ Design Load (in.)	Inside Dia. (in.)	Wire Dia. (in.)	Deflection Rate @ Ground (lbs. per in. ea.)
F-250/F-350 4x2	3800	12.5	4.3	.799	638
	3950	12.5	4.3	.799	638
	4100	12.5	4.3	.810	677
	4250	12.5	4.3	.810	677
	4400	12.5	4.3	.830	716
	4550	12.5	4.3	.830	716
	4700	12.5	4.3	.870	745
	4850	12.5	4.3	.870	745
	5000	12.5	4.3	.880	780
	5250	12.5	4.3	.880	780
F-250/F-350 4x4	4000	14.7	4.1	.670	349
	4400	14.7	4.1	.690	383
	4800	14.7	4.1	.720	410
	5200	14.7	4.1	.730	430
	5600	14.7	4.1	.760	469
	6000	14.7	4.1	.770	499
F-450 4x4	5200	14.7	4.1	.730	430
	5600	14.7	4.1	.760	469
	6000	14.7	4.1	.770	499
	6500	14.7	4.1	.800	553

SPRING SPECIFICATIONS — REAR LEAF

Super Duty Series/Model	Combined Rating @ Ground (lbs.)	No. of Leaves	Total Thickness @ Pad ⁽¹⁾ (in.)	Overall Length (in.)	Width (in.)	Deflection Rate (lbs. per in./ Spring) ^{(2) (3)}	Rating Each @ Pad (lbs. per Spring)
Main Leaf Pack and Auxiliary Spring (Including Auxiliary Spacer)							
F-250 Pickup ⁽⁴⁾	6100	4	4.75	66.3	3.00	349/654/1174	3133
F-250 Pickup ⁽⁵⁾	6100	5	6.21	66.3	3.00	343/686/1639	3133
F-350 Pickup ⁽⁶⁾	7000	4	4.75	66.3	3.00	349/654/1174	3133
F-350 SRW Pickup ⁽⁷⁾	7000	5	6.21	66.3	3.00	343/686/1639	3133
F-350 DRW Pickup	9000	5	5.48	66.3	3.00	448/930/1800	4289
F-450	9000	5	5.48	66.3	3.00	448/930/1800	4289
Main Leaf Pack Only							
F-250 Pickup ⁽⁸⁾	6100	3	3.28	66.3	3.00	324/782	2695
F-250 Pickup ⁽⁹⁾	6100	4	3.62	66.3	3.00	314/650	2695

(1) Includes top plate.

(2) Pickup and Box Delete models include two-stage, variable-rate springs.

(3) Lists first stage/second stage/third stage as applicable.

(4) Auxiliary rear spring available and included with Camper Package and Heavy Service Package for Pickup Box Delete only (all 4x4 only; 4x2 Gasoline 156.2" and 158.0"; 4x2 Diesel 156.2", 158.0" and 172.4").

(5) Auxiliary rear spring included with Camper Package and Heavy Service Package for Pickup Box Delete only (4x2 Gasoline 172.4"; 4x2 137.0" and 141.8").

(6) 4x2 Gasoline 156.2" and 158.0"; 4x2 Diesel 156.2", 158.0" and 172.4"; 4x4 156.2", 158.0" and 172.4" .

(7) 4x2 Gasoline 172.4"; 4x2 and 4x4 137.0" and 141.8" .

(8) 4x2 Gasoline 141.8"; 4x2 Diesel 137.0" and 141.8"; 4x2 and 4x4 156.2", 158.0" and 172.4"; 4x4 Gasoline 137.0"; 4x4 Diesel 137.0" and 141.8" .

(9) 4x2 Gasoline 137.0"; 4x4 Gasoline 141.8" .

NOTE: Please see the Major Product Summary pages and/or the Dealer Ordering Guide for availability.

Revised September 2013

esourcebook.dealerconnection.com

RE&T: 2014 Source Book

Tires and Wheels

TIRE SPECIFICATIONS

Size	Tread Type and Sidewall	Rim Width (in.)	Section Width (in.) ⁽¹⁾	Ply/Load Rating	Max. Inflation Press. (psi)	Load Limits @ Max. Inflation Press. (lbs.)	Static Loaded Radius (in.)	Revolutions Per Mile @ 45 mph
LT245/75Rx17	A/S-BSW	7.5/6.5 ⁽²⁾	10.11	10/E	80	3195/2910 ⁽²⁾	14.57	660
LT245/75Rx17	A/T-BSW and OWL	7.5/6.5 ⁽²⁾	9.76	10/E	80	3195/2910 ⁽²⁾	14.61	663
LT265/70Rx17 ⁽³⁾	A/T OWL	7.5	10.71	10/E	80	3195	14.72	660
LT275/65Rx18 ⁽³⁾	A/S-BSW	8.0	10.98	10/E	80	3415	14.95	652
LT275/70Rx18 ⁽³⁾	A/T-BSW and OWL	8.0	11.25	10/E	80	3640	15.50	628
LT275/65Rx20 ⁽³⁾	A/T OWL	8.0	11.1	10/E	80	3750	16.00	605

(1) Tire and rim maximum width.

(2) Single Rear Wheel/Dual Rear Wheel: Rim Width and Load Rating.

(3) Single Rear Wheel only.

WHEEL SPECIFICATIONS

Wheel Type	Wheel Size	Nominal Inset mm (in.)	No. of Studs	Bolt Circle mm (in.)	Max. Wheel Capacity Load (lbs. @ ground)
Argent Painted Steel (F-250/F-350 SRW)	17" x 7.5" J	40 (1.57)	8	170 (6.7)	3195
Cast Aluminum (F-250/F-350 SRW)	17" x 7.5" J	40 (1.57)	8	170 (6.7)	3195
Argent Painted Steel (F-350 SRW)	18" x 8.0" J	40 (1.57)	8	170 (6.7)	3590
Bright Machined Aluminum (F-250/F-350 SRW)	18" x 8.0" J	40 (1.57)	8	170 (6.7)	3590
6-spoke Aluminum (F-250/F-350 SRW)	18" x 8.0" J	40 (1.57)	8	170 (6.7)	3590
Polished Aluminum (F-250/F-350 SRW 4x4)	20" x 8.0" J	40 (1.57)	8	170 (6.7)	3590
Argent Painted Steel (F-350 DRW)	17" x 6.5" J	142 (5.55)	8	200 (7.87)	3195
Forged Polished Aluminum (F-350/F-450 DRW)	17" x 6.5" J	142 (5.55)	8	200 (7.87)	3195
King Ranch Aluminum (F-250/F-350 SRW 4x4)	20" x 8.0" J	40 (1.57)	8	170 (6.7)	3590

Transfer Case

TRANSFER CASE SPECIFICATIONS

Make and Model	Manual T-Case (MSOS)	Electronic T-Case (ESOF)
Application	Manual Mechanical Shift-On-Stop (manual shift lever)	Electric Shift-On-the-Fly (rotary switch control)
Super Duty Series/Model	F-250/F-350/F-450	
Type	2-speed Planetary Gears	
Lubricant Capacity (pt.)	4.0	
Gear Ratio — High Range	1.00:1	
Gear Ratio — Low Range	2.72:1	
Case Material	Aluminum	

NOTE: Please see the Major Product Summary pages and/or the Dealer Ordering Guide for availability.

Super Duty Pickups F-250/F-350/F-450

Technical Specifications cont'd

2014

Transmission

AUTOMATIC TRANSMISSION SPECIFICATIONS

Make/Type	Heavy-duty TorqShift 6-speed SelectShift Automatic Overdrive
Application	6.2L 2V SOHC V8 (E85 Flex Fuel) and 6.7L 4V Power Stroke Turbo Diesel (B20)
Ratios (to 1):	
1st	3.97
2nd	2.31
3rd	1.51
4th	1.14
5th	0.85
6th	0.67
Reverse	3.12
Converter Torque Ratio @ WOT Stall	1.9 (6.2L, 6.7L)
Lubricant Capacity (qts.)	16.2 Qts./ 15.3 Liters (6.7L), 17.2 Qts./ 16.2 Liters (6.2L)
Power Takeoff Data	6.7L V8 Diesel only (Available)
Opening	SAE 6-bolt, LH Side
Gear ratio	1.00 Direct Drive
Pitch line diameter velocity @ 1000 engine rpm (ft./min.)	1118
rpm @ 1000 engine rpm	1000
Number of teeth	52
Pitch diameter (in.)	4.27055 in. (108.472 mm)
Module	2.086
Normal pressure angle	19.339°
Helix angle	RH Spur Gear

UREA (DEF) DIESEL AFTERTREATMENT SPECIFICATIONS

Availability	Location	Capacity (gallons)	Tank Type
Diesel Pickup	Inboard on Frame Rail	5.0	Plastic (Urea Corrosive to Metal)

1. Ford material spec: WSS-M99C130-A.
2. Heated urea delivery module (urea freezes at -12°F).
3. Urea solution: -32% ammonia (NH3) solution in water.
4. Tanks can be filled using either bottles or nozzle.
5. Fluid is corrosive.
6. Fluid is nonflammable.
7. Supply lines are heated and are wheelbase dependent for wide frames (x5), and cab length dependent on narrow frames (x3). Lines are formed; however they are somewhat flexible.
8. Vehicle operation will degrade as urea levels reach extremely low levels since this is an emission-regulated component. Vehicle speed will be gradually lowered to zero if operator takes no action to refill the tank.

NOTE: Please see the Major Product Summary pages and/or the Dealer Ordering Guide for availability.

Revised September 2013

esourcebook.dealerconnection.com

RE&T: 2014 Source Book

Super Duty Pickups
F-250/F-350/F-450

Pickup Box Delete/Removal

Refer to the latest Body Builders Layout Book. Also refer to the Weight Ratings Charts in this section.

Trailer Towing/Camper Information

For additional towing information, refer to the RV & Trailer Towing Guide, available as a printable PDF on eSourceBook, or the vehicle owner manual.

Power Takeoff

Refer to the latest Body Builders Layout Book. Also refer to the Transmission Specification Charts in this section.

Snowplow Installation/Minimum Required and Recommended Equipment

The Super Duty F-Series vehicles tabled below are available for snowplow usage.

Minimum Required Equipment

- Snowplow Package, includes:
 - Front spring/GAWR upgrade (refer to the Weight Ratings charts on pages 72–78 for specific spring/GAWR selection for each model)
 - 157-amp, heavy-duty alternator (6.2L). Available: dual alternators 357-amp (6.7L diesel)
 - Plow and attaching hardware weight limits are as tabled below

Recommended Equipment

- All-terrain tires and roof clearance lights (available with SRW Pickup models, required with F-350 DRW and F-450)

Standard Equipment

- Front and rear stabilizer bar (rear standard on Chassis Cab and DRW Pickup models)
- Roof clearance lights (standard on Chassis Cab and required on Pickup models)
- Steering damper
- Engine oil cooler, auxiliary automatic transmission oil cooler and maximum capacity engine coolant radiator are standard
- All available axle ratios are acceptable
- When snowplowing, operate automatic transmission with shift lever in overdrive position

Vehicles Available for Snowplow Applications

F-250-450 4x4 Pickup/Box Delete Models (with driver and one passenger)

Cab Style	Wheelbase	Engine	F-250 4x4 17" tires ⁽¹⁾	F-350 SRW 4x4 18" tires ⁽¹⁾	F-350 DRW 4x4	F-450 4x4
Regular Cab	137.0"	6.2L V8	100/1005	100/1005	100/1005	—
		6.7L V8 Diesel	100/1005	100/1005	100/1005	—
SuperCab	141.8"	6.2L V8	100/1005	100/1005	—	—
		6.7L V8 Diesel	100/950	100/950	—	—
SuperCab	158.0"	6.2L V8	100/1005	100/1005	100/1005	—
		6.7L V8 Diesel	100/800	100/850	100/800	—
Crew Cab	156.2"	6.2L V8	100/1005	100/1005	—	—
		6.7L V8 Diesel	100/800	100/850	—	—
Crew Cab	172.4"	6.2L V8	100/1005	100/1005	100/1005	—
		6.7L V8 Diesel	100/750	100/750	100/650	100/650

LEGEND: 100/750 = Maximum 100 lbs. of permanently attached hardware/Maximum 750 lbs. of removable plow blade and hardware. The plow and hardware weight limits shown are based upon a vehicle with 33% EPA option content and 150 lbs. each for the driver and one front-seat passenger.

(1) Considering max. GAWR and A/T tires.

NOTE: Please see the Major Product Summary pages and/or the Dealer Ordering Guide for availability.

Super Duty Pickups F-250/F-350/F-450

Special Applications cont'd

2014

Completed Vehicle Weight

The weight of the completed vehicle with equipment installed (and second unit body, if applicable) must not exceed the front GAWR, rear GAWR or GVWR established by Ford, with consideration for the driver and one front-seat passenger. If sufficient weight is added such that the completed vehicle with a driver and more than one passenger would exceed front GAWR, rear GAWR or GVWR, it is the responsibility of the equipment installer to notify the customer of the appropriate use restrictions (i.e., that the user should limit occupancy of the vehicle to the driver and one passenger while the equipment is installed). The addition of ballast weight, placed rearward of the rear axle, may be required to prevent front-end overloading or exceeding front GAWR. If required, the ballast weight must be securely attached to the vehicle. For Ford completed vehicles of 10,000 lbs. GVWR or less, the weight of permanently attached equipment must not exceed the Total Accessory Reserve Capacity (TARC) as specified on the Safety Compliance Certification Label. Permanently attached equipment includes the snowplow frame-mounting hardware, and does not include the removable snowplow blade assembly. Exceeding TARC will require recertification.

Front-end Wheel Alignment and Headlight Aim

Front-end wheel alignment (toe) and headlight aim may require readjustment after installation of equipment, and is the responsibility of the equipment installer. Failure to reset front wheel alignment may cause premature uneven tire wear. If required, reset to chassis manufacturer's specifications found in the Ford Shop Manual.

Electrical Connections

Installation of any inductive load devices (i.e., electric motors, electric clutches for clutch pumps, etc.) MUST NOT be connected to OEM wiring or fuse panels. Power for such devices should be taken directly from the battery or starter motor relay power terminal. Control of these devices should be achieved via relays. No direct current path should exist between OEM wiring and the installed load that is not filtered by the battery. These recommendations are intended to reduce or eliminate any induced reverse voltage into the OEM circuitry.

Warranty

The normal Ford New Vehicle Limited Warranty applies to vehicles with snowplows installed in accordance with these guidelines. Consult your Ford dealer or the owner manual for any further questions.

NOTE: Please see the Major Product Summary pages and/or the Dealer Ordering Guide for availability.

April 2013

esourcebook.dealerconnection.com

RE&T: 2014 Source Book